

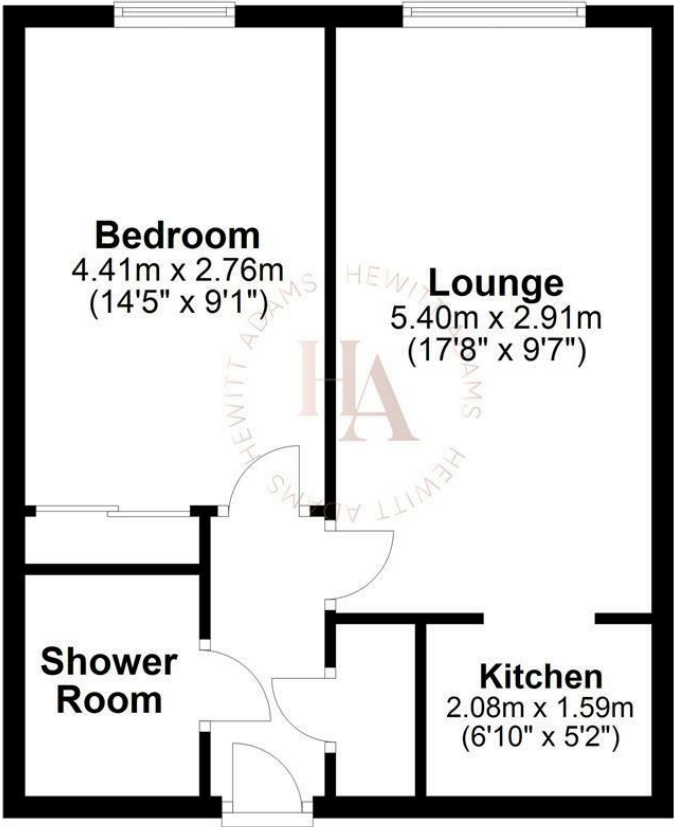

Ground Floor

Approx. 40.9 sq. metres (439.8 sq. feet)



Total area: approx. 40.9 sq. metres (439.8 sq. feet)  
For illustration purposes only - not to scale



Hesslewell Court, Heswall, Wirral CH60 7TW

£89,950

1 Bedroom   1 Reception   1 Bathroom  

**\*\*GROUND FLOOR - One Bedroom Retirement Flat - Garden View - Central Location - No Chain!\*\***

Hewitt Adams is pleased to offer to the market this well presented ONE BEDROOM Retirement property for the over 55's in the popular Hesslewell Court in Heswall. A short walk from Telegraph Road and the centre of town's amenities.

Hesslewell Court is always popular due to it's sought after location and the well proportioned sizes of the flats. There are well tended communal areas such as gardens and a residents lounge, laundry room and also on site lifts to ensure all flats are easily accessible for all.

A particular selling feature with this property is the fact that it is GROUND FLOOR which offers an attractive view across the garden and other communal areas. It is RARE for these ground floor units to come available.

In brief the accommodation affords: entrance, lounge, kitchen, bedroom and bathroom. There are pull-cords in each room and there is an on-site house manager during the mornings.

Call Hewitt Adams on 0151 342 8200 to book a viewing.

Entrance

Into;

Lounge

17'8" x 10'0" (5.4 x 3.07)

Double glazed window, heater, fireplace, power points, opens to;

Kitchen

5'1" x 7'0" (1.56 x 2.15)

Wall and base units. inset sink, space for white goods

Bedroom

13'10" x 8'10" (4.22 x 2.70)

Integral wardrobes, heater, double glazed window, power points

Shower-Room

Comprising shower, low level w.c, wash hand basin

Additional Information

Ground Rent - £320 per annum approx

Service Charges - £480 per quarter

Council tax band B

Lease length - TBC

Parking - residents and guest spaces available

